

FLANGE TYPE DIN 86044

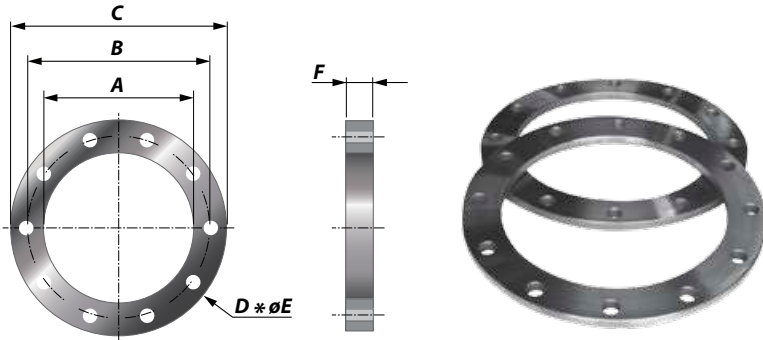

| Article No. | Size (Inch) | NB (mm) | Pipe (mm) | A (mm) | B (mm) | C (mm) | D Number of holes | E Diameter of holes (mm) | F (mm) | Weight (kg) |
|--------------|-------------|---------|-----------|--------|--------|--------|-------------------|--------------------------|--------|-------------|
| 212020160100 | 10 | 250 | 273.0 | 276 | 335 | 375 | 12 | 18 | 16 | 6 |
| 212020160120 | 12 | 300 | 323.9 | 327 | 395 | 440 | 12 | 22 | 16 | 8 |
| 212020160140 | 14 | 350 | 355.6 | 360 | 445 | 490 | 12 | 22 | 16 | 10 |
| 212020160160 | 16 | 400 | 406.4 | 411 | 495 | 540 | 16 | 22 | 16 | 11 |
| 212020160180 | 18 | 450 | 457.2 | 461 | 550 | 595 | 16 | 22 | 16 | 13 |
| 212020160200 | 20 | 500 | 508.0 | 512 | 600 | 645 | 20 | 22 | 16 | 14 |
| 212020200220 | 22 | 550 | 560.0 | 563 | 650 | 703 | 20 | 22 | 20 | 20 |
| 212020200240 | 24 | 600 | 609.6 | 614 | 700 | 754 | 20 | 22 | 20 | 22 |
| 212020200260 | 26 | 650 | 664.0 | 665 | 750 | 805 | 20 | 22 | 20 | 24 |
| 212020200280 | 28 | 700 | 711.2 | 716 | 800 | 856 | 24 | 22 | 20 | 25 |
| 212020200300 | 30 | 750 | 762.0 | 767 | 860 | 907 | 24 | 22 | 20 | 27 |
| 212020200320 | 32 | 800 | 812.8 | 818 | 900 | 958 | 24 | 22 | 20 | 29 |
| 212020200360 | 36 | 900 | 914.4 | 920 | 1010 | 1060 | 28 | 22 | 20 | 32 |
| 212020200380 | 38 | 950 | 698.0 | 970 | 1060 | 1110 | 28 | 22 | 20 | 34 |
| 212020200400 | 40 | 1000 | 1016.0 | 1022 | 1110 | 1167 | 32 | 22 | 20 | 36 |
| 212020200440 | 44 | 1100 | 1120.0 | 1126 | 1210 | 1266 | 32 | 22 | 20 | 39 |
| 212020200480 | 48 | 1200 | 1220.0 | 1226 | 1310 | 1366 | 36 | 22 | 20 | 42 |
| 212020200520 | 52 | 1300 | 1324.0 | 1326 | 1410 | 1466 | 40 | 22 | 20 | 45 |

CHARACTERISTICS

Flanges Hole pattern according type DIN 86044

Material Flanges are produced out of Steel S235JRG2

Range Diameter range from 273 mm up to 1324 mm

Thickness From minimum 16 mm up to maximum 20 mm

Temperature The maximum allowable temperature is 600°C