

FLANGE TYPE JIS B2220 - 10K

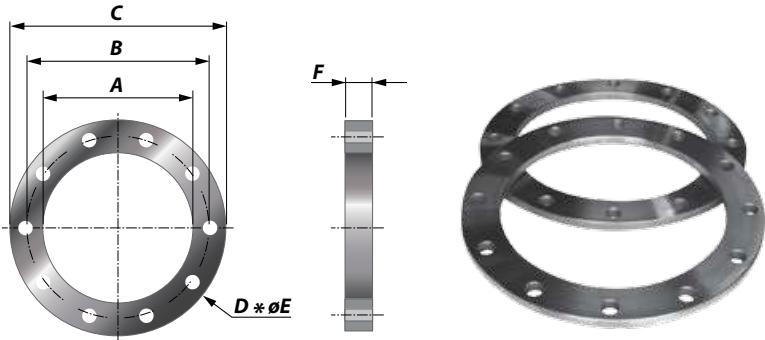

| Article No. | Size (Inch) | NB (mm) | Pipe (mm) | A (mm) | B (mm) | C (mm) | D Number of holes | E Diameter of holes (mm) | F (mm) | Weight (kg) |
|--------------|-------------|---------|-----------|--------|--------|--------|-------------------|--------------------------|--------|-------------|
| 212050140010 | 1 | 25 | 34.5 | 35 | 90 | 125 | 4 | 19 | 14 | 1 |
| 212050160013 | 1.25 | 32 | 43.2 | 43 | 100 | 135 | 4 | 19 | 16 | 2 |
| 212050160015 | 1.5 | 40 | 49.1 | 49 | 105 | 140 | 4 | 19 | 16 | 2 |
| 212050160020 | 2 | 50 | 61.1 | 61 | 120 | 155 | 4 | 19 | 16 | 2 |
| 212050180025 | 2.5 | 65 | 77.1 | 77 | 140 | 175 | 4 | 19 | 18 | 3 |
| 212050180030 | 3 | 80 | 90.0 | 90 | 150 | 185 | 8 | 19 | 18 | 3 |
| 212050180040 | 4 | 100 | 115.4 | 116 | 175 | 210 | 8 | 19 | 18 | 3 |
| 212050200050 | 5 | 125 | 141.2 | 142 | 210 | 250 | 8 | 23 | 20 | 5 |
| 212050220060 | 6 | 150 | 166.6 | 167 | 240 | 280 | 8 | 23 | 22 | 6 |
| 212050220080 | 8 | 200 | 218.0 | 218 | 290 | 330 | 12 | 23 | 22 | 8 |
| 212050240100 | 10 | 250 | 269.5 | 270 | 355 | 400 | 12 | 25 | 24 | 12 |
| 212050240120 | 12 | 300 | 321.0 | 321 | 400 | 445 | 16 | 25 | 24 | 14 |
| 212050260140 | 14 | 350 | 358.1 | 358 | 445 | 490 | 16 | 25 | 26 | 16 |
| 212050280160 | 16 | 400 | 409.0 | 409 | 510 | 560 | 16 | 27 | 28 | 23 |
| 212050300180 | 18 | 450 | 460.0 | 460 | 565 | 620 | 20 | 27 | 30 | 30 |
| 212050300200 | 20 | 500 | 511.0 | 511 | 620 | 675 | 20 | 27 | 30 | 34 |
| 212050320240 | 24 | 600 | 613.0 | 613 | 730 | 795 | 24 | 33 | 32 | 46 |
| 212050340280 | 28 | 700 | 715.0 | 715 | 840 | 905 | 24 | 33 | 34 | 60 |
| 212050360320 | 32 | 800 | 817.0 | 817 | 950 | 1020 | 28 | 33 | 36 | 76 |
| 212050380360 | 36 | 900 | 919.0 | 919 | 1050 | 1120 | 28 | 33 | 38 | 89 |
| 212050400400 | 40 | 1000 | 1021.0 | 1021 | 1160 | 1235 | 28 | 39 | 40 | 109 |

CHARACTERISTICS

Flanges Hole pattern according type JIS Standard

Material Flanges are produced out of Steel S235JRG2

Range Diameter range from 34.5 mm up to 1021 mm

Thickness From minimum 14 mm up to maximum 40 mm

Temperature The maximum allowable temperature is 600°C