

BLIND FLANGE TYPE DIN 2573 - PN6

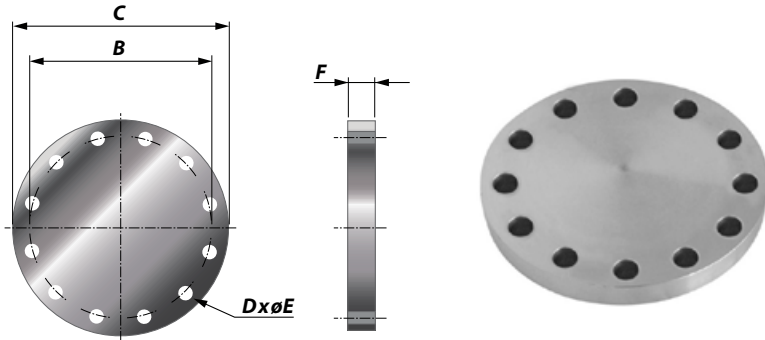

Article No.	Size (Inch)	NB (mm)	Pipe (mm)	B (mm)	C (mm)	D Number of holes	E Diameter of holes (mm)	F (mm)	Weight (kg)
212000120010	1	25	33.4	75	100	4	11	12	1
212000120013	1.25	32	42.2	90	120	4	14	12	1
212000120015	1.5	40	48.3	100	130	4	14	12	1
212000120020	2	50	60.3	110	140	4	14	12	1
212000120025	2.5	65	76.1	130	160	4	14	12	2
212000120030	3	80	88.9	150	190	4	18	12	3
212000120040	4	100	114.3	170	210	4	18	12	3
212000160050	5	125	139.7	200	240	8	18	16	6
212000160060	6	150	168.3	225	265	8	18	16	7
212000160080	8	200	219.1	280	320	8	18	16	10
212000160100	10	250	273.0	335	375	12	18	16	14
212000160120	12	300	323.9	395	440	12	22	16	19
212000160140	14	350	355.6	445	490	12	22	16	24
212000160160	16	400	406.4	495	540	16	22	16	29
212000160180	18	450	457.2	550	595	16	22	16	36
212000200200	20	500	508.0	600	645	20	22	16	42
212000200240	24	600	609.6	705	755	20	26	20	72
212000200280	28	700	711.2	810	860	24	26	20	93
212000200320	32	800	812.8	920	975	24	30	20	119
212000200360	36	900	914.4	1020	1075	24	30	20	145
212000200400	40	1000	1016.0	1120	1022	28	30	20	173

CHARACTERISTICS

Flanges Hole pattern according type DIN2573 - PN6 Standard

Material Flanges are produced out of Steel S235JRG2

Range Diameter range from 34.4 mm up to 1016 mm

Thickness From minimum 14 mm up to maximum 40 mm

Temperature The maximum allowable temperature is 600°C